



24key Wifi Smart App Control Led Lighting Controller For Rgb Led Light Strip

Our Product Introduction

for more products please visit us on ledslightstrip.com

Basic Information

- Place of Origin: Guangdong, China
- Brand Name: Linkop
- Certification: CE
- Model Number: LCSD-24K-wifi
- Minimum Order Quantity: 10pcs
- Price: \$3.6/Pcs
- Packaging Details: bag
- Delivery Time: 3-8 days
- Payment Terms: TT
- Supply Ability: 300000pcs/ month



Product Specification

- Max Load Current: 12A
- Output Port: 4 PIN
- Mobile App: Yes
- Working Voltage: DC5V-24V
- Control Distance: 5-10 Meters
- Smart Connect: WIFI
- Adjust Brightness: Yes
- Mode: MUSIC/Voice Control
- Highlight: App Control Led Lighting Controller, 24key Led Lighting Controller, Rgb Led Lighting Controller



More Images

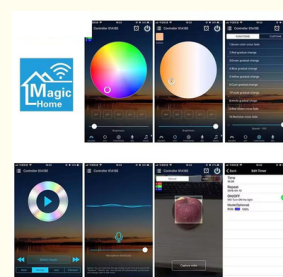

Product Description

24key Wifi Smart App Control Led Lighting System Control For Rgb Led Light Strip

Product Description:

This controller is compatible with RGB LED strips and designed for 4-pin output ports. This allows you to easily connect to your LED lighting system and start controlling your lights at any time.

The controller has a range of different modes to choose from, including music and voice control. In music mode, the controller will synchronize with your music rhythm, creating a stunning visual display that takes your party to the next level. In voice control mode, the controller will respond to your voice commands, allowing you to easily change the color and pattern of the lights.

With a 24 key controller, you can easily change the color of your lights to suit your mood or occasion. The controller comes in a range of different colors to choose from, including red, green, blue, yellow, and white. Just use the remote control to select the color you want and observe the changes in your lighting.

The controller is designed to be easy to use and features a simple 4-pin connection mode, allowing you to quickly and easily connect it to LED lighting systems. Make it easy to set up and use.

Overall, if you are looking for a high-quality LED lighting system controller that is easy to use and provides complete control over your RGB LED lights, then a 24 key RGB controller is the perfect solution. Whether you want to create a stunning visual display for your next gathering or just add some atmosphere to your home or office, this controller is sure to meet your needs.

Features:

Product Name: led wifi controller

Applicable types: RGB

Mobile app: Yes

Battery: CR2025 Battery 1pcs

Control Distance: 5-10 Meters

Connection mode: 4 PIN

Remote controller: Yes

LED lighting system control: Yes

led controller: Yes

Technical Parameters:

Applicable types:	RGB
Max Load Current:	12A
Network Protocol:	IR
Connection mode:	4 PIN
Change color:	Yes
Input port:	DC
Smart Connect:	Bluetooth APP
Output port:	4 PIN
Working Voltage:	DC5V-24V
Control Distance:	5-10 Meters

Applications:

Linkop LCSD-24K-wifi LED Controller is a versatile product that can be used in various occasions and scenarios. It is widely used for LED strip lights, LED modules, and other LED products. The controller is manufactured in Guangdong, China, and has CE certification. The minimum order quantity for this product is 10pcs, and it is packed in a bag. The delivery time is 3-8 days, and the payment terms are TT. The supply ability is 300000pcs per month.

The Linkop LCSD-24K-wifi LED Controller has a working voltage of DC5V-24V, and its connection mode is 4 PIN. The output port is also 4 PIN, which is compatible with most LED products. The controller has two modes - MUSIC and Voice Control, which are perfect for parties and events. The input port can be DC or USB, which makes it easy to use with different devices.

The Linkop LCSD-24K-wifi LED Controller comes with a remote controller, which allows users to control their LED lights from a distance. The remote controller has 24 keys, and it is easy to use. Users can change the color, brightness, and mode of their LED lights with just a

few clicks. The remote controller is small and lightweight, which makes it easy to carry around.

The Linkop LCSD-24K-wifi LED Controller also comes with a mini controller, which is perfect for those who want to control their LED lights without a remote. The mini controller is small and easy to use. Users can change the mode and color of their LED lights with just a few clicks.

The Linkop LCSD-24K-wifi LED Controller can be used in various occasions and scenarios. It is perfect for parties, events, and decorations. It can be used in homes, offices, bars, and restaurants. Users can create different moods and atmospheres with their LED lights, which makes this product perfect for any occasion.

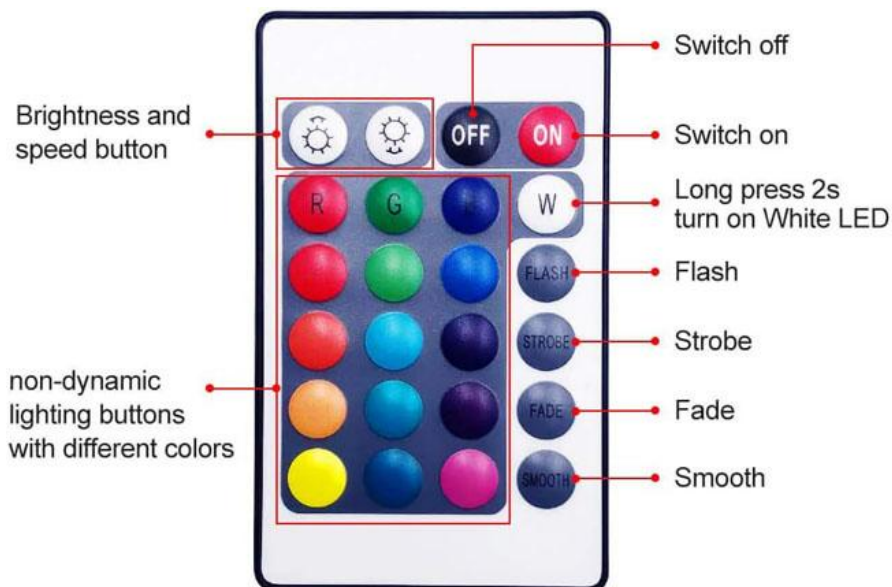
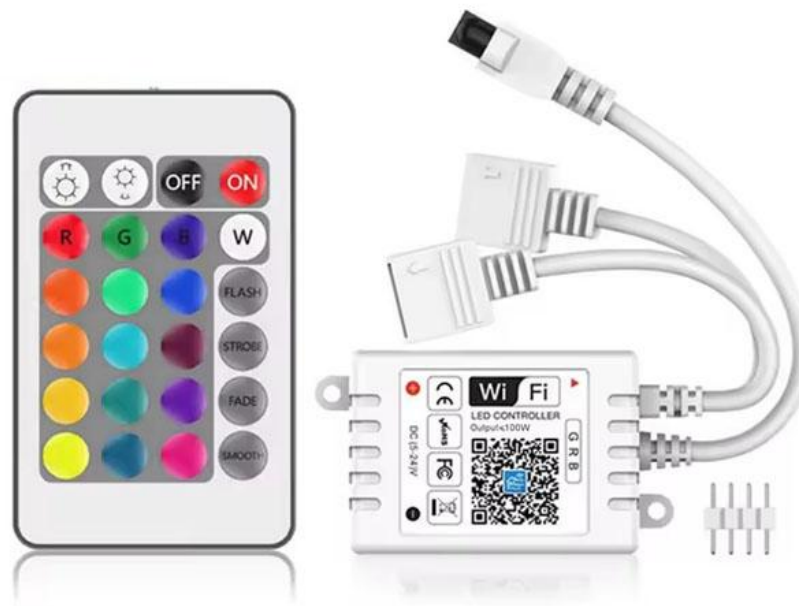

Instruction of Remote Controller

24-key infrared control instruction: (For controllers with infrared function)

The default setting of the WIFI controller is 4 channels in the sequence of RGBW. (sequence of GRB for RGB version, GRBWC for RGBWC version). If you want to change the output channel, the steps are as follows: unplug the controller power and then plug in again. When the light up, long press the G key for 2 to 3s, the flickering white light means you've successfully changed the output channel to GRBW; Similarly, long press key R to RGBW sequence.

In RGBW version, press **W** key for RGB and white light; long press **W** key for 2 seconds will switch on White LED.



Light Dancing with Music:

The connected LED light lights up depending on the volume/noise from the outside like a microphone. This also works when playing music or there is a noise from outside the light will begin dancing base on different rhythm.

LINKOP® Shenzhen Lianchuang Shengda Electronic Technology Co., Ltd

+8613430440444

HSH20062023@outlook.com

ledlightstrip.com

Building 6B, Jingnan Industrial Zone, Jingnan Road, Buji Street, Longgang District, Shenzhen

