



Long Strip LED Motion Sensor Wardrobe Light 3000K/4500K/6000K

Our Product Introduction

for more products please visit us on ledslightstrip.com

Basic Information

- Place of Origin: Guangdong, China
- Brand Name: LINKOP
- Certification: CE/FCC/ROHS
- Model Number: LC-MZ-L2901
- Minimum Order Quantity: 10pcs
- Price: \$7.15/Pcs
- Packaging Details: color box
- Delivery Time: 3-8 days
- Payment Terms: TT
- Supply Ability: 200000pcs/ month



Product Specification

- Light Source: LED
- Color Temperature: 3000K/4500K/6000K
- Brightness: Adjustable
- Type: Motion Sensor Light
- Sensor Angle: 120 Degrees
- Waterproof: No
- Sensor Range: Up To 10 Feet
- Material: ABS, Aluminum
- Highlight: Long Strip Motion Sensor Wardrobe Light, LED Motion Sensor Wardrobe Light, Motion Sensor Wardrobe Light 3000K



More Images

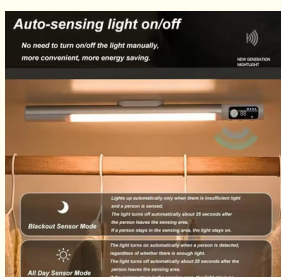

Product Description

Long Strip Motion Sensor, Wardrobe Light, No Wiring, Charging Capacity Display

Product Description:

The LED motion sensor light is equipped with a motion sensor that allows it to automatically turn on when motion is detected within its sensor range. This feature not only saves your energy, but also helps keep your space safe.

Our LED motion sensor lights are CE/FCC/ROHS certified, ensuring they meet the highest safety standards. In addition, its magnetic installation characteristics make it easy to install and disassemble, without leaving any residue or damaging the surface of its installation. As long as the magnetic strip is attached to the desired surface, light will magnetically adhere to the magnetic strip.

The LED motion sensor light is powered by a USB 5V power supply, making it an environmentally friendly and cost-effective lighting solution. It can be easily charged using any USB port and can provide up to 6-8 hours of continuous use on a single charge.

Although not waterproof, the design of LED motion sensor lights is perfect for illuminating any space to withstand normal indoor use, without the need for wiring or installation.

In summary, LED motion sensor lights are an energy-saving and cost-effective lighting solution that is highly suitable for use in wardrobes, display cabinets, cabinets, office desks, stairs, and even bedside tables. Its motion sensor function, CE/FCC/ROHS certification, magnetic installation, and USB 5V power supply make it the perfect lighting solution for any indoor space.

Features:

Product Name: LED motion sensor light

Type: Motion Sensor Light

Size: One

Sensor Type: Motion Sensor

Color Temperature: 3000K/4500K/6000K

Material: ABS+Aluminum

Features: Angle adjustment is added to the traditional motion sensor cabinet light

Magnetic installation

Automatic light

Magnetic attraction without wiring

Technical Parameters:

Sensor Range:	Up To 10 Feet
Size:	One
Power Source:	Rechargeable Lithium-ion Battery
Waterproof:	No
Sensor Type:	Motion Sensor
Dimensions:	1200/2000mAh
Light Source:	LED
Brightness:	Adjustable
Material:	ABS+Aluminum
Installation Method:	Magnetic Installation

Applications:

One of the most common uses for this LED motion sensor light is as a wardrobe light. It can be easily installed in a closet or wardrobe to provide ample light when selecting clothing or accessories. The motion sensor feature ensures that the light turns on as soon as you open the door, and turns off when you close it. This not only saves battery life, but also provides a convenient hands-free experience.

Another great use for this product is as a night light. Its adjustable brightness and warm color temperature make it perfect for creating a soothing and relaxing environment in the bedroom. The motion sensor feature ensures that the light turns on when you enter the room, and turns off after a set amount of time, allowing you to fall asleep comfortably without worrying about turning off the light.

The Motion Sensor Cabinet Light is also a great choice for use in a garage or workshop. Its bright, cool light and motion sensor feature make it easy to find tools and work on projects in a well-lit environment. The large capacity battery ensures that it will last for hours on a

single charge, making it a reliable and convenient choice for any workspace.

In conclusion, whether you need a wardrobe light, a night light, or a work light, the Motion Sensor Cabinet Light is a great choice. With its adjustable brightness, warm color temperature, and motion sensor feature, it is a versatile solution for any lighting need. Its rechargeable lithium-ion battery and sensor range of up to 10 feet make it a reliable and convenient choice for any scenario.

Product Attributes:

Brand Name: Motion Sensor Cabinet Light

Model Number: LC-MZ-L2901

Place of Origin: Guangdong, China

Certification: CE/FCC/ROHS

Minimum Order Quantity: 10pcs

Packaging Details: color box

Delivery Time: 3-8 days

Payment Terms: TT

Supply Ability: 200000pcs/ month

Power Source: Rechargeable Lithium-ion Battery

Brightness: Adjustable

Color Temperature: 3000K/4500K/6000K

Sensor Range: Up To 10 Feet

Dimensions: 1200/2000mAh



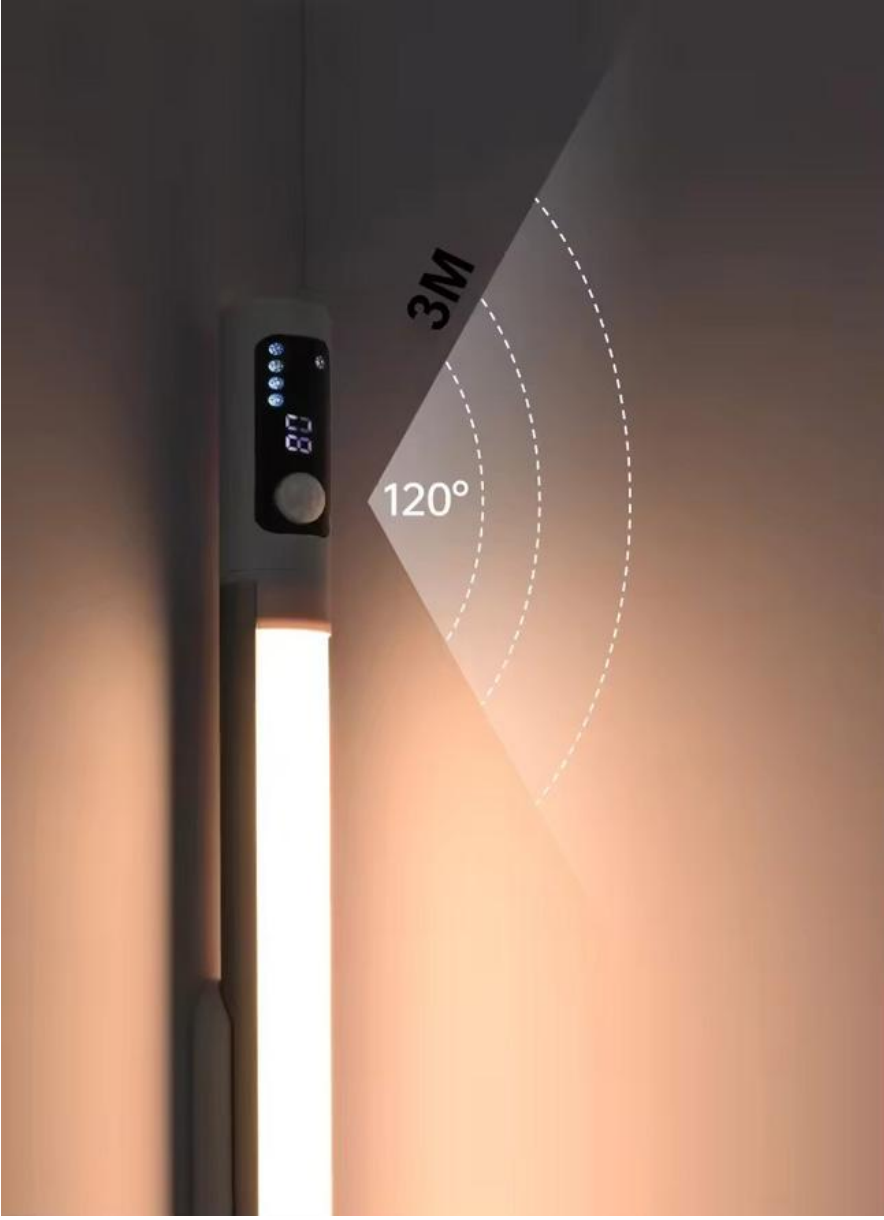

Wireless Magnetic suction installation



Step 1: Fix the base on the surface



Step 2: Put on light on the base



Digital display

battery/brightness/modes are Clearly visible



Sensor adjustable

make it more sensing activated



Big battery capacity

long working time+type C input





LINKOP® Shenzhen Lianchuang Shengda Electronic Technology Co., Ltd

+8613430440444

HSH20062023@outlook.com

ledslightstrip.com

Building 6B, Jingnan Industrial Zone, Jingnan Road, Buji Street, Longgang District, Shenzhen